



HK蜗轮丝杆升降机

动力传动专业制造商

PROFESSIONAL MANUFACTURER OF POWER TRANSMISSION

设计理念: 遵循规律, 总是超越

DESIGN PHILOSOPHY: To follow the law, but always beyond.

经营理念: 为客户需求而设计, 为客户满意而执着

BUSINESS PHILOSOPHY: Design for customer demand, dedication for customer satisfaction

HK蜗轮丝杆升降机系列
HK Worm gear screw lifter series



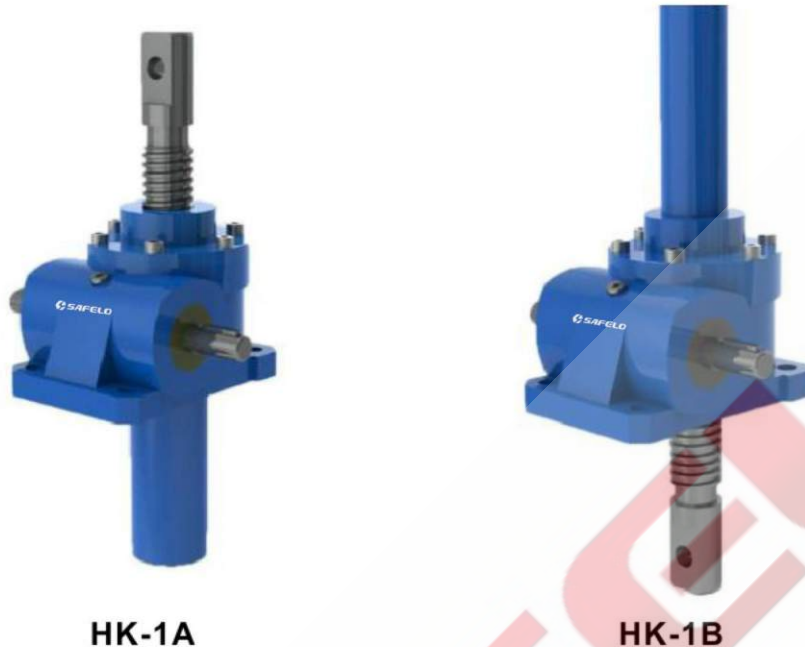

HK-1A

HK-1B

示例：

HK 5T - 6 - 1 - A - II - 100 - FZ - C

1. **HK**：系列号，HK系列-蜗轮+T型丝杆升降机；
2. **5T**：型号，以升降机的静载能力作为型号；主要有：2T，3T，5T，10T，15T，20T，30T，40T，50T，100T；
3. **6**：升降机速比；
4. **1**：结构型号；1型：螺母作旋转运动、丝杆作轴向运动（本页展示的产品均为I型）；2型：丝杆作旋转运动、螺母作轴向运动；
5. **A**：装配型式；A型：丝杆（或螺母）向上（安装面）移动；B型：丝杆（或螺母）向下（安装面）移动；
6. **T**：丝杆头部型式：1型丝杆头部分为I型（圆柱型）、II型（法兰型）、III型（螺纹型）、IV型（扁头型）四种；2型丝杆头部分为I型（圆柱型）、III型（螺纹型）；
7. **100**：升降行程；客户自定义；
8. **FZ**：丝杆的防旋和防护；
1型结构有基本型、防旋型（F-键防旋）和带防护罩型（Z钢管防护-被动侧，X伸缩管防护-主动侧，Q两种都有）；
2型结构有基本型和带防护罩型（X伸缩管防护-主动侧）；
9. **C**：轴指向A；B；C；

HK初选表

类别 \ 型号	单位	HK2T	HK3T	HK5T	HK10T	HK15T	HK20T	HK30T	HK40T	HK50T	HK100T
最大起升力	KN	20	30	50	100	150	200	300	400	500	1000
最大拉伸力	KN	20	30	50	100	150	200	300	400	500	1000
丝杆参数		Tr26×5	Tr32×6	Tr38×6	Tr46×8	Tr52×8	Tr65×10	Tr75×12	Tr80×12	Tr90×14	Tr100×16
速比I		5	6	6	8	8	10	12	12	7	8
对应蜗杆每转丝杆提升量	mm	1	1	1	1	1	1	1	1	2	2
对应升降效率	%	21	21	19	18	19	15	15	14	12	12
速比II		10	12	12	16	16	20	18	18	14	16
对应蜗杆每转丝杆提升量	mm	0.5	0.5	0.5	0.5	0.5	0.5	0.66	0.66	1	1
对应升降效率	%	18	18	18	17	18	15	14	13	12	11
速比III		20	24	24	32	32	40	36	36	28	32
对应蜗杆每转丝杆提升量	mm	0.25	0.25	0.25	0.25	0.25	0.25	0.33	0.33	0.5	0.25
对应升降效率	%	11	17	17	16	17	11	13	12	10	9
外壳材料		球磨	球磨	球磨	球磨	球磨	球磨	球磨	球磨	球磨	球磨

HK2T I型结构

1A丝杆向上

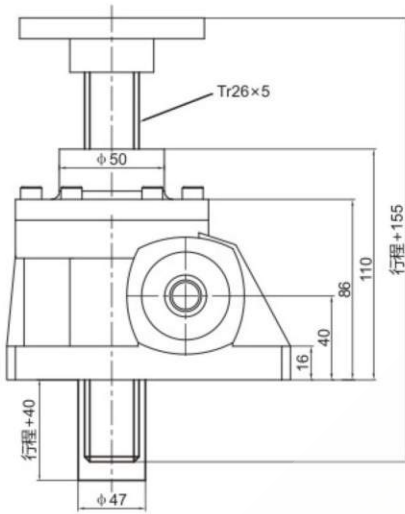

1B丝杆向下

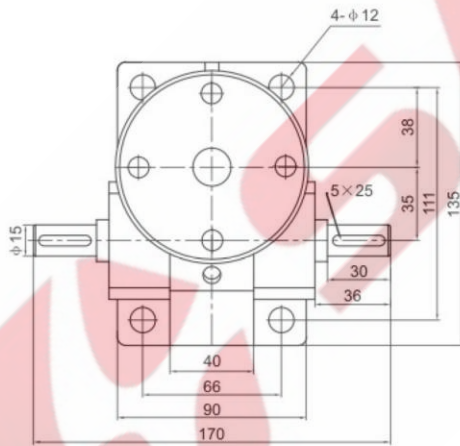
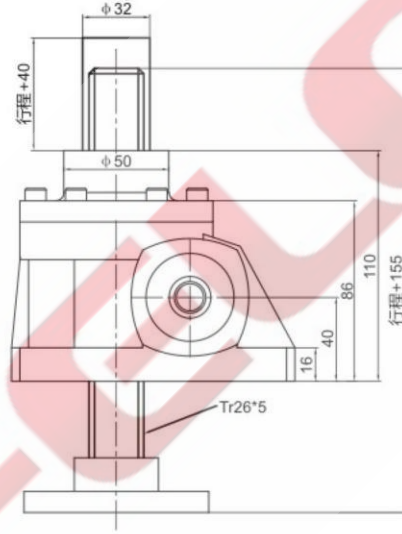

丝杆头部可选

I型

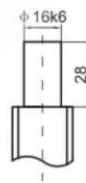

II型

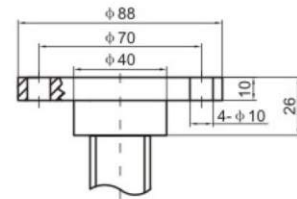

III型

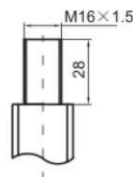

IV型

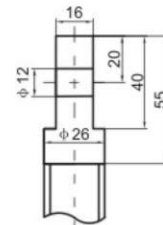

轴指向 Shaft Direction

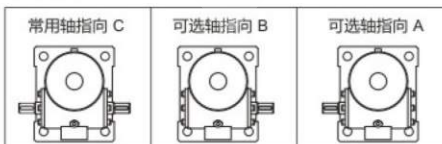

HK..

HK3T I型结构

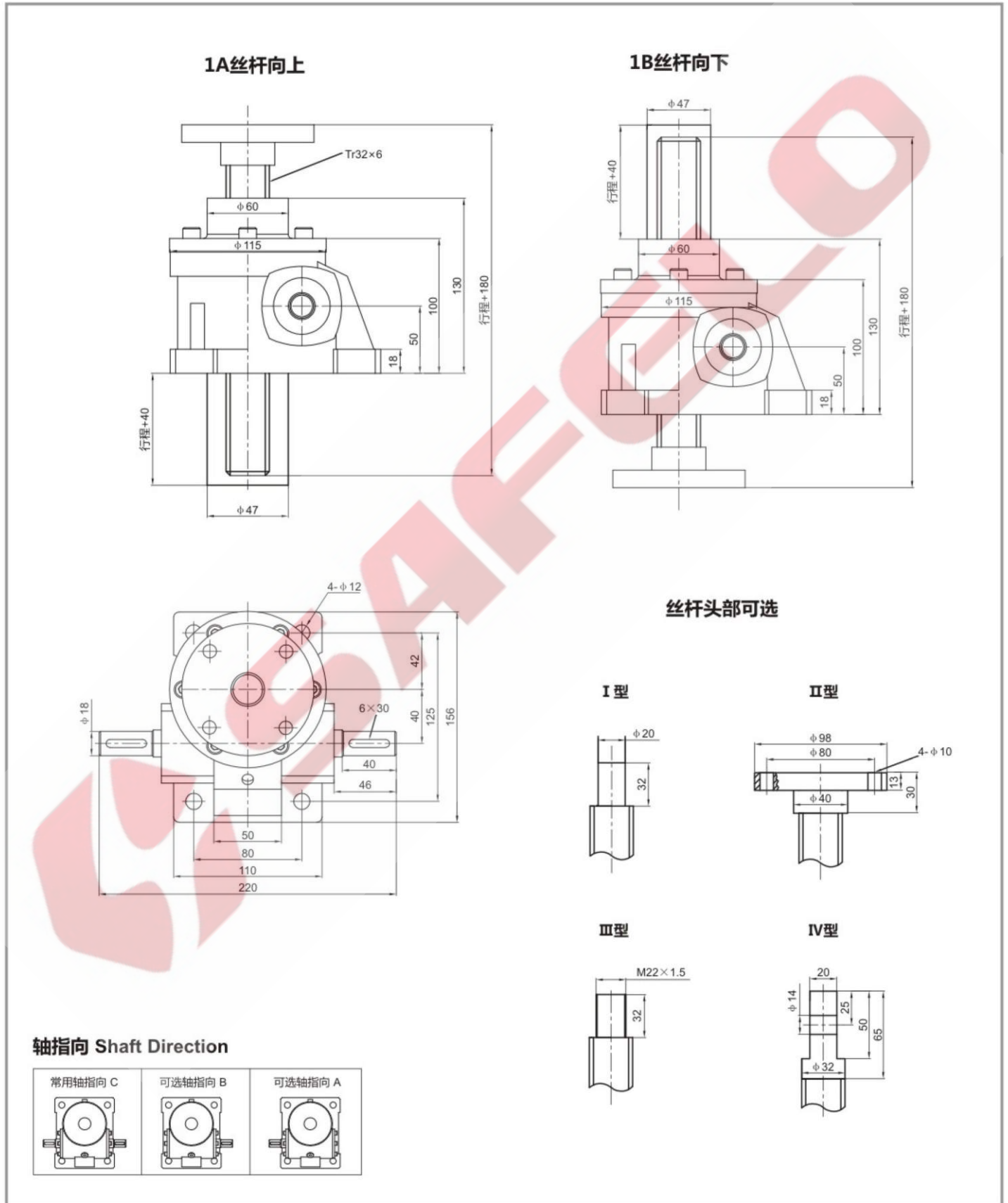

HK5T I型结构

1A丝杆向上

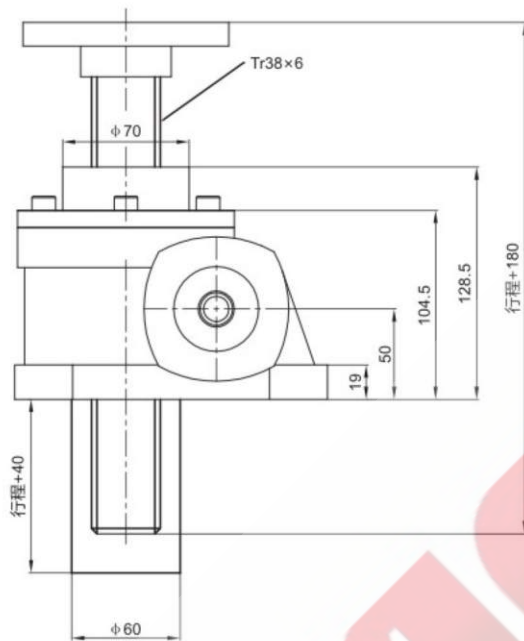

1B丝杆向下

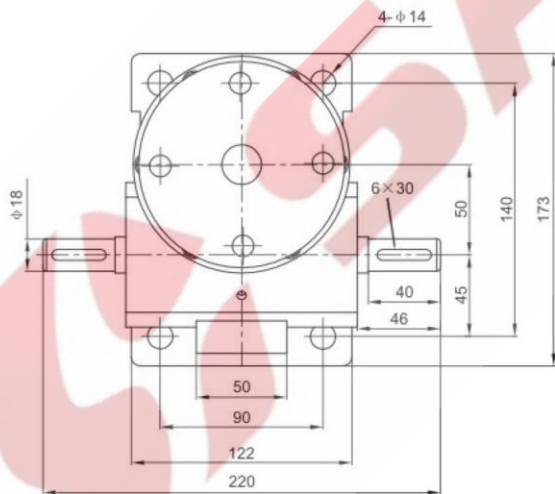
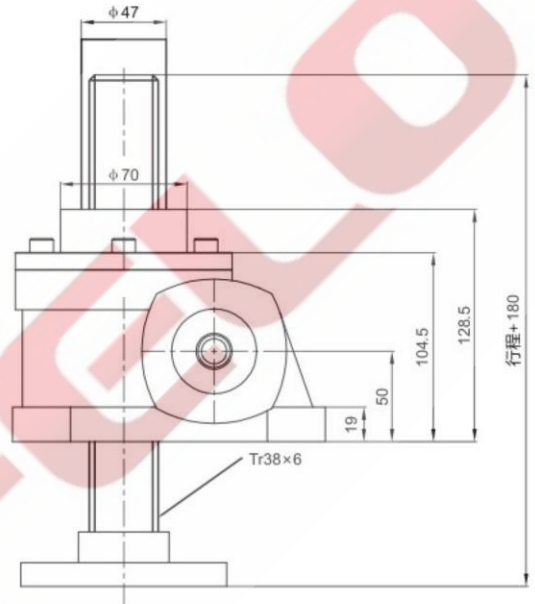

丝杆头部可选

I型

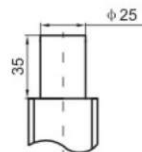

II型

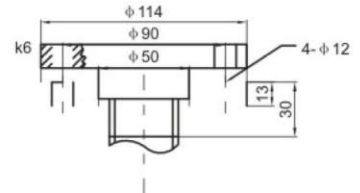

III型

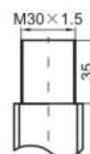

IV型

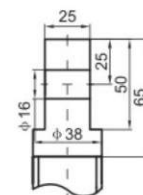

轴指向 Shaft Direction

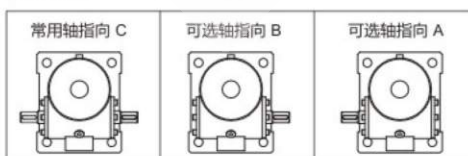

HK15T I型结构

1A丝杆向上

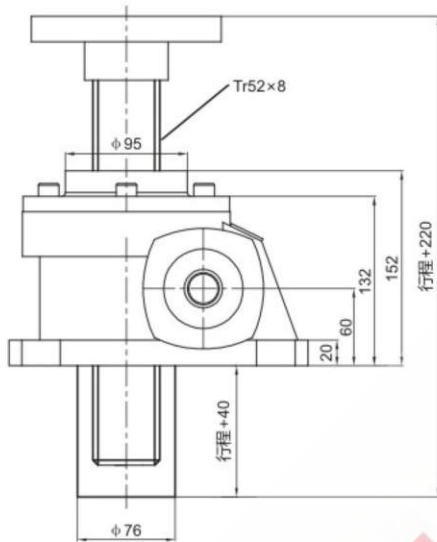

1B丝杆向下

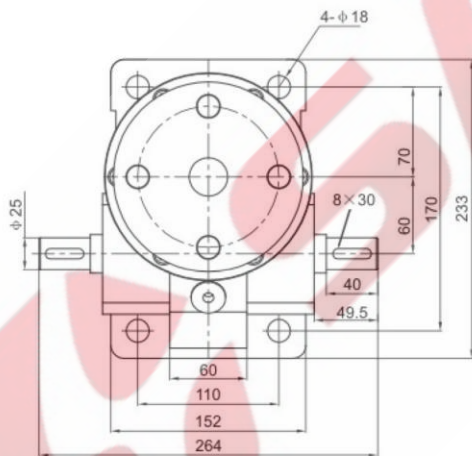
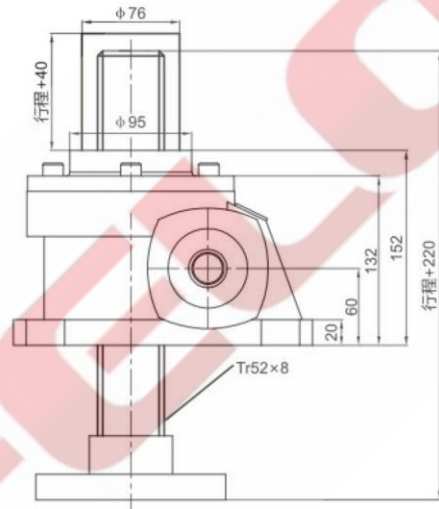

丝杆头部可选

I型

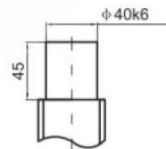

II型

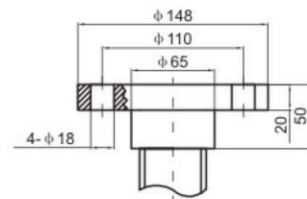

III型

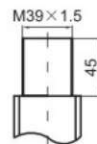

IV型

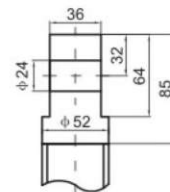

轴指向 Shaft Direction

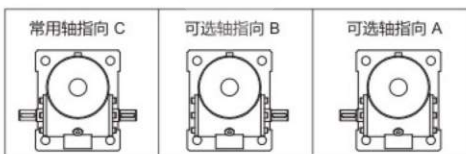

HK

HK20T I型结构

1A丝杆向上

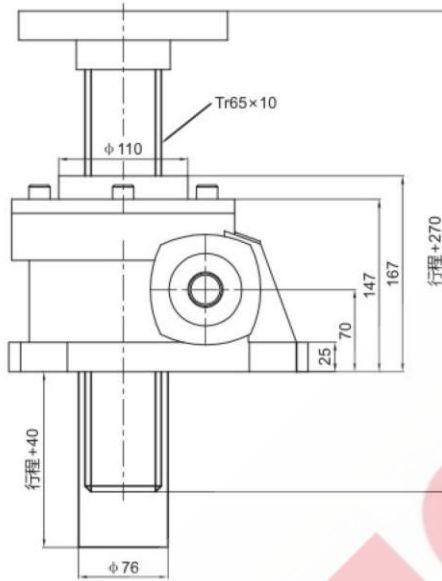

1B丝杆向下

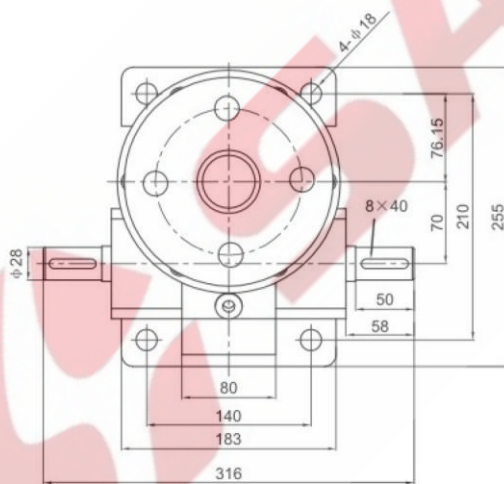
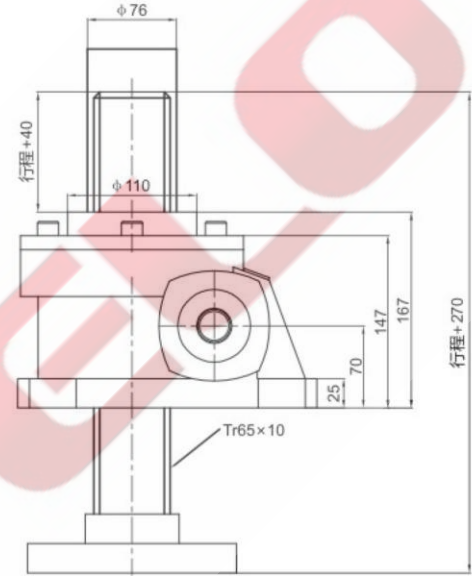

丝杆头部可选

I型



II型

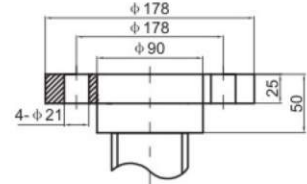

III型

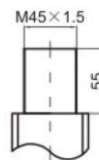

IV型

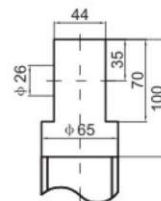

轴指向 Shaft Direction

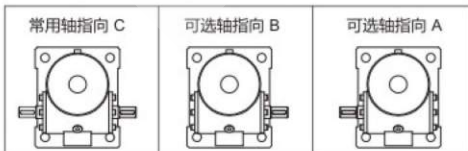

HK30T I型结构

1A丝杆向上

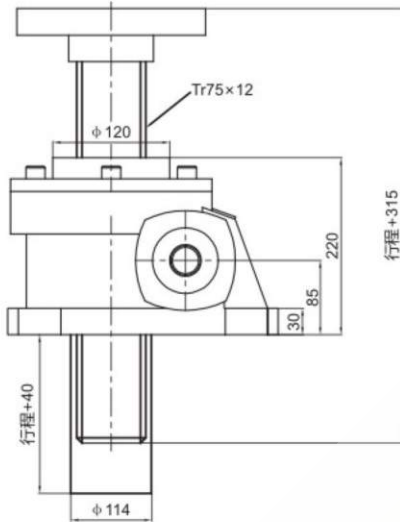

1B丝杆向下

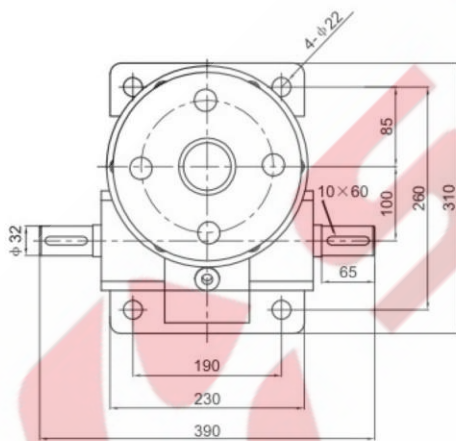
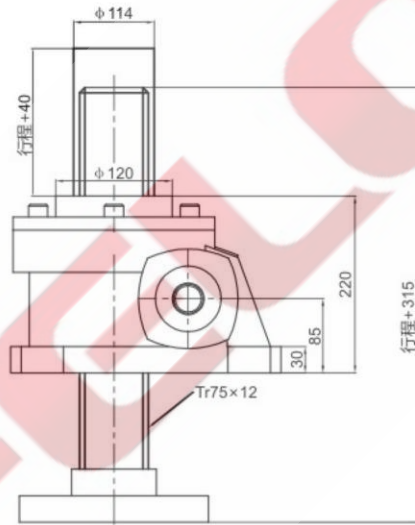

丝杆头部可选

I型

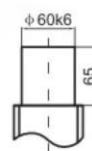

II型

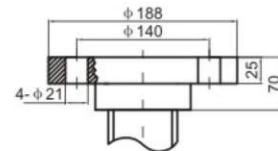

III型

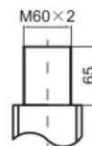

IV型



轴指向 Shaft Direction

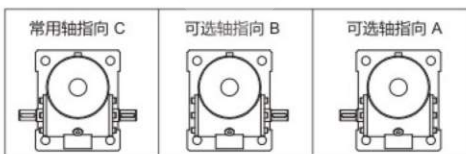

HK..

HK40T I型结构

1A丝杆向上

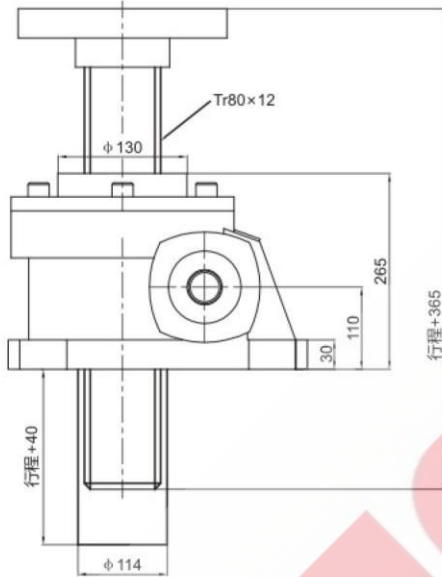

1B丝杆向下

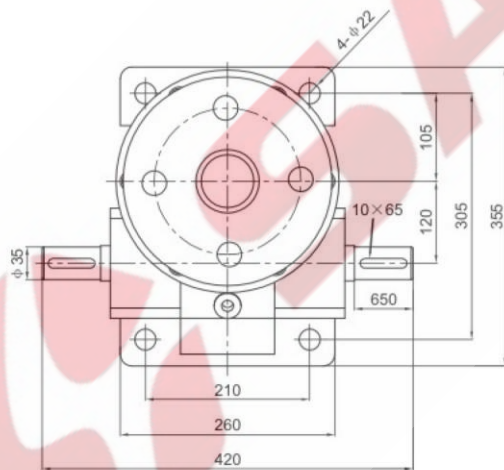
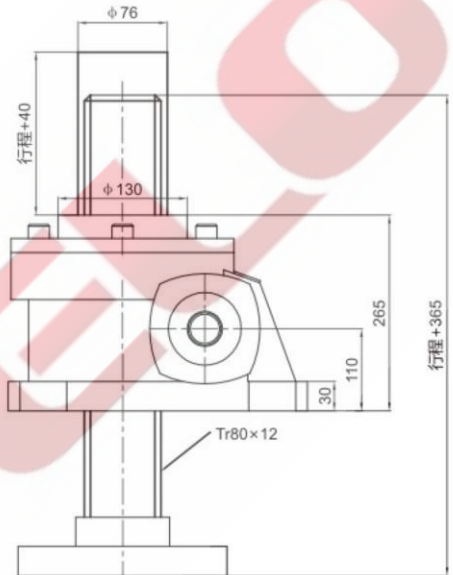

丝杆头部可选

I型

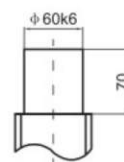

II型

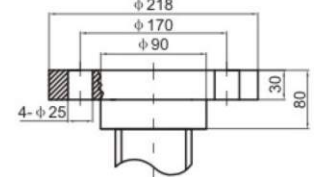

III型

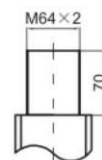

IV型

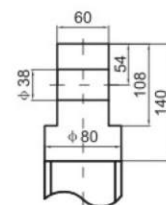

轴指向 Shaft Direction

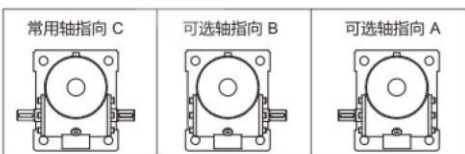

HK50T I型结构

1A丝杆向上

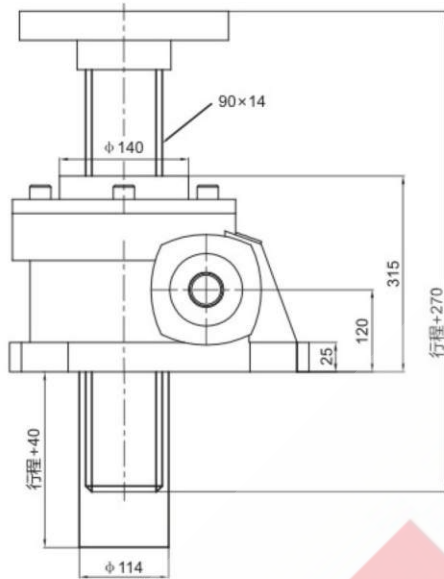

1B丝杆向下

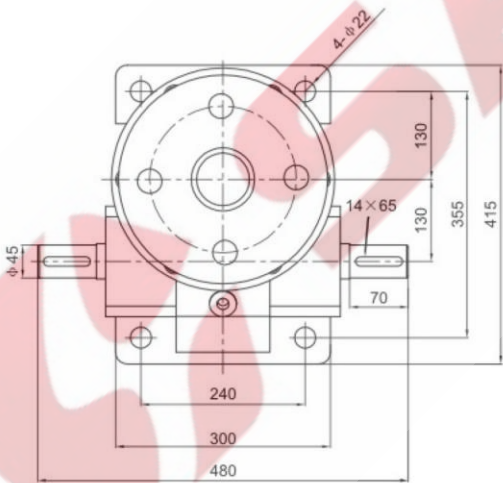
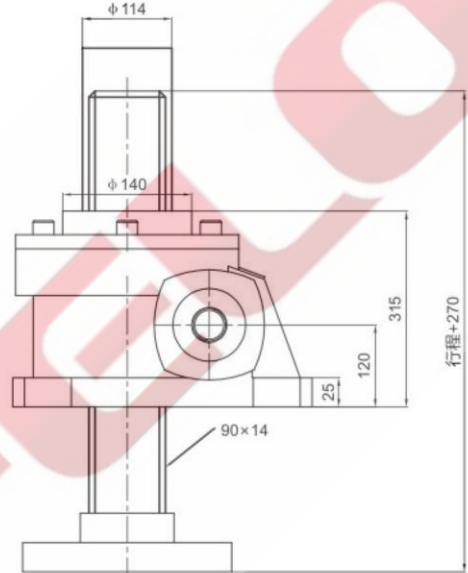

丝杆头部可选

I型

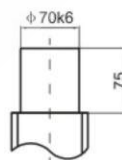

II型

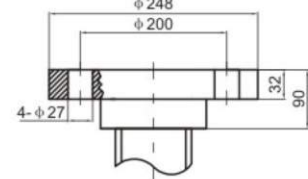

III型

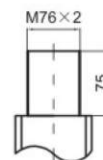

IV型



轴指向 Shaft Direction

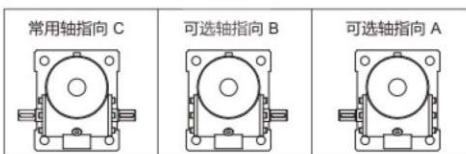

HK..

HK100T I型结构

1A丝杆向上

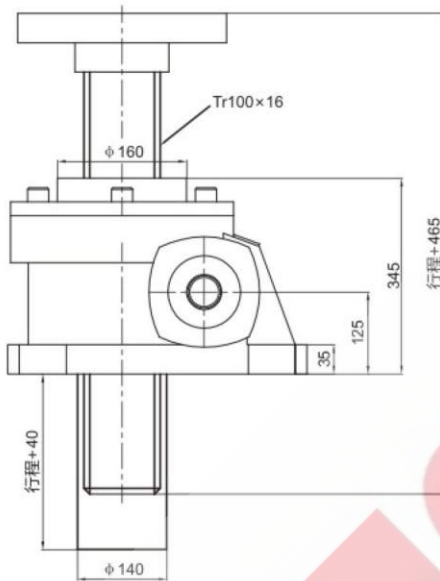

1B丝杆向下

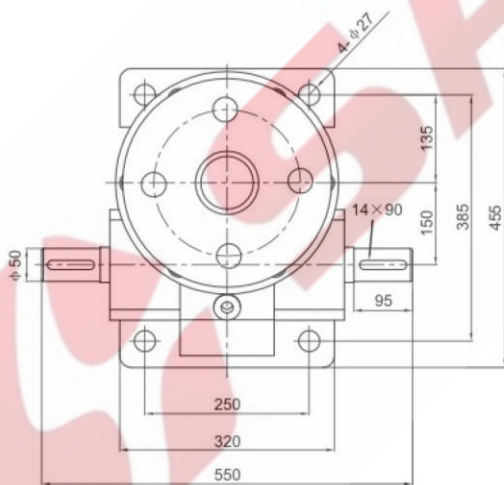
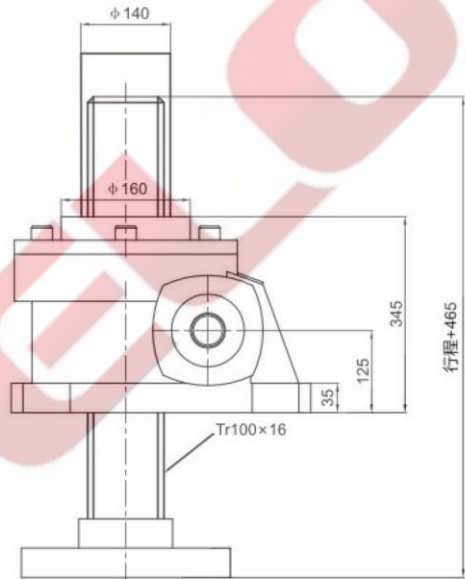

丝杆头部可选

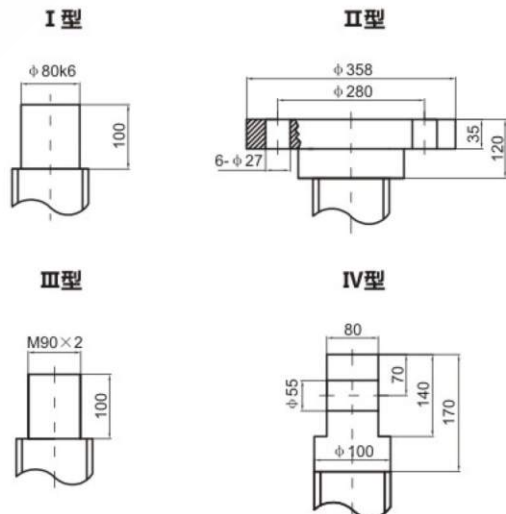

轴指向 Shaft Direction

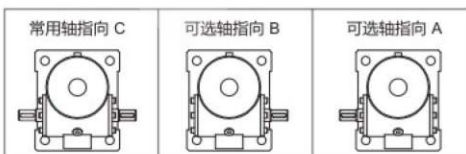



HK-2A

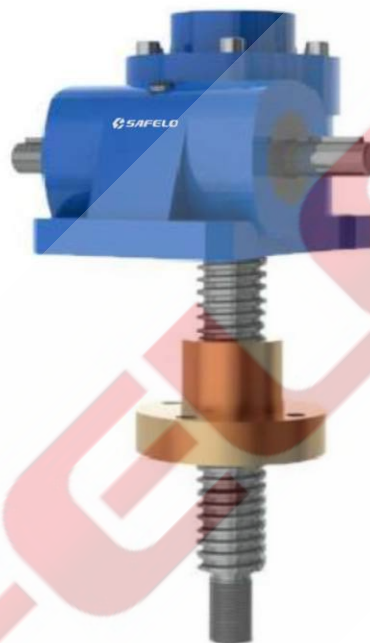

HK-2B

示例：

HK 5T - 6 - 1 - A - II - 100 - FZ - C
1 2 3 4 5 6 7 8 9

1. **HK**：系列号，HK系列-蜗轮+T型丝杆升降机；
2. **5T**：型号，以升降机的静载能力作为型号；主要有：2T，3T，5T，10T，15T，20T，30T，40T，50T，100T；
3. **6**：升降机的速比；
4. **1**：结构型号；1型：螺母作旋转运动、丝杆作轴向运动（本页展示的产品均为1型）；2型：丝杆作旋转运动、螺母作轴向运动；
5. **A**：装配型式；A型：丝杆（或螺母）向上（安装面）移动；B型：丝杆（或螺母）向下（安装面）移动；
6. **T**：丝杆头部型式：1型丝杆头部分为I型（圆柱型）、II型（法兰型）、III型（螺纹型）、IV型（扁头型）四种；
2型丝杆头部分为I型（圆柱型）、III型（螺纹型）；
7. **100**：升降行程；客户自定义；
8. **FZ**：丝杆的防旋和防护；
1型结构有基本型、防旋型（F-键防旋）和带防护罩型（Z钢管防护-被动侧，X伸缩管防护-主动侧，Q两种都有）；
2型结构有基本型和带防护罩型（X伸缩管防护-主动侧）；
9. **C**：轴指向A；B；C；

HK..

HK2T II型结构

2A螺母在上

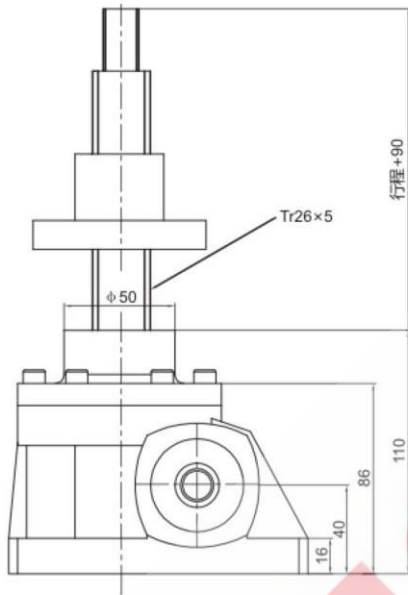

2B螺母在下

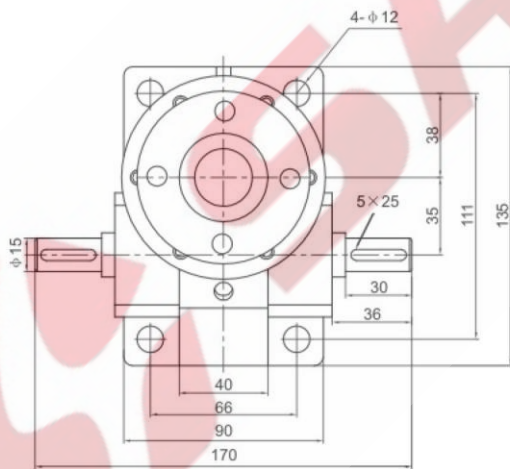
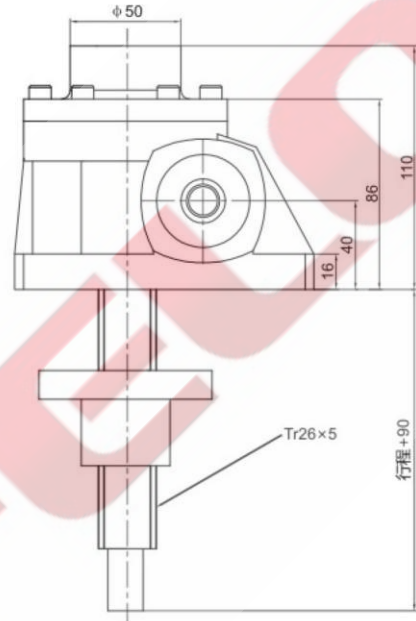

丝杆头部可选

I型



III型

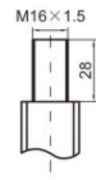

2型丝杆螺母

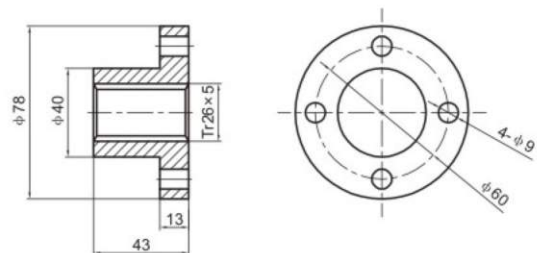

轴指向 Shaft Direction

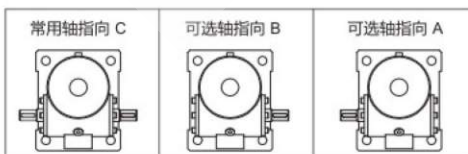

HK..

HK3T II型结构

2A螺母在上

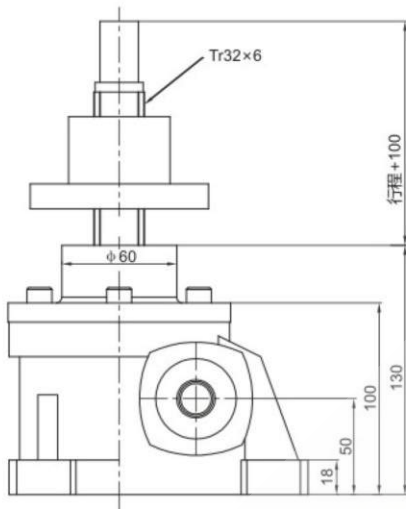

2B螺母在下

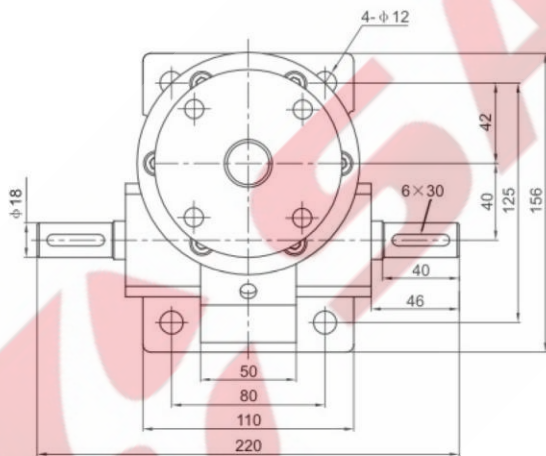
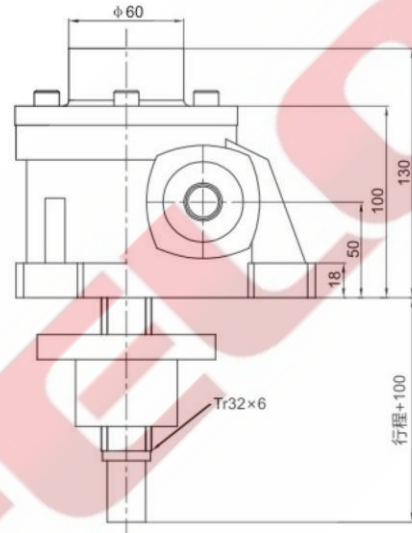

丝杆头部可选

I型

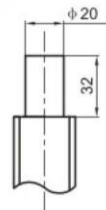

III型

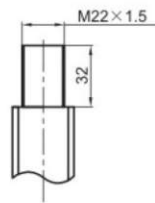

2型丝杆螺母

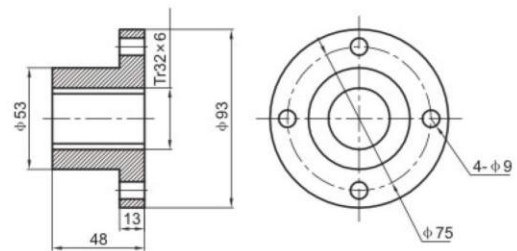

轴指向 Shaft Direction

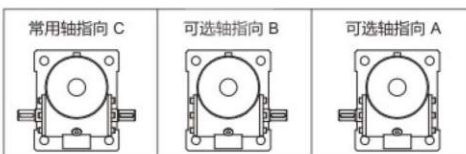

HK..

HK5T II型结构

2A螺母在上

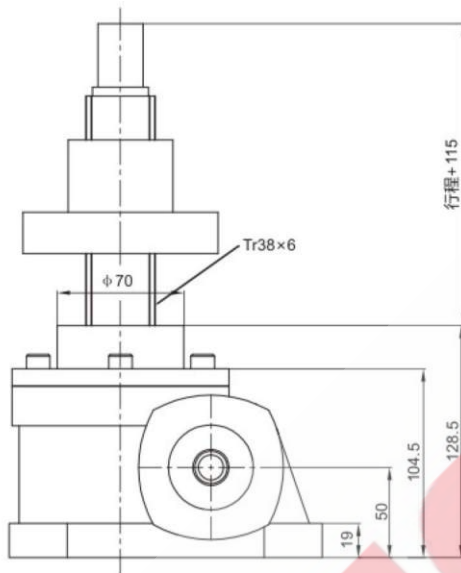

2B螺母在下

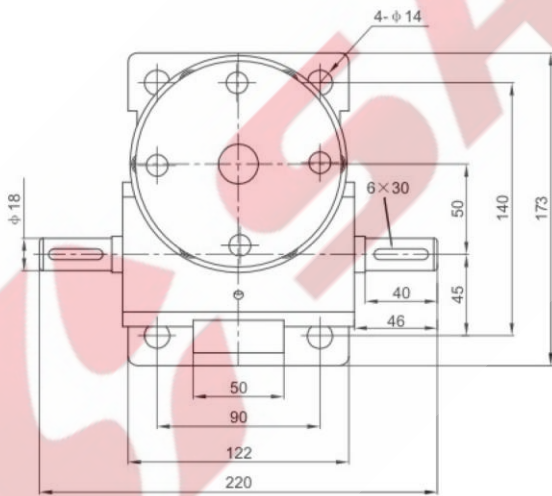
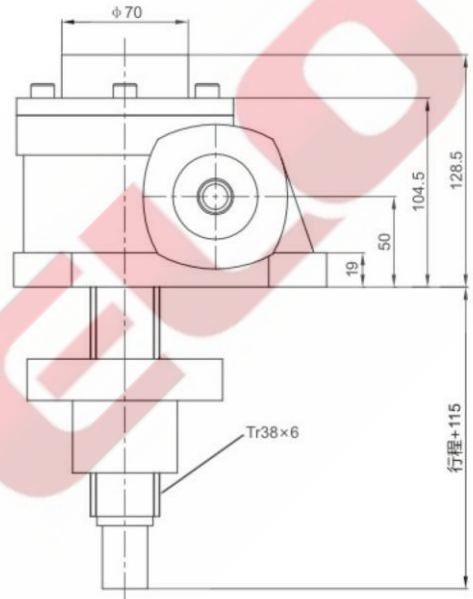

丝杆头部可选

I 型

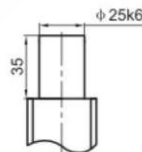

III 型



2型丝杆螺母

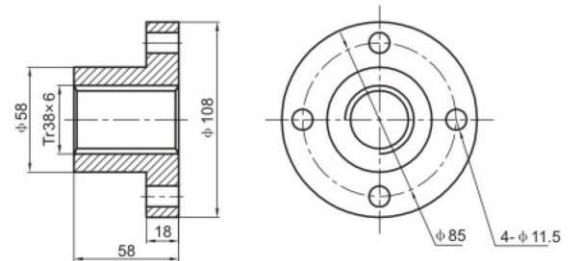

轴指向 Shaft Direction

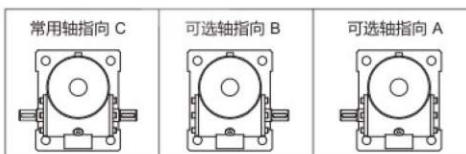

HK10T II型结构

2A螺母在上

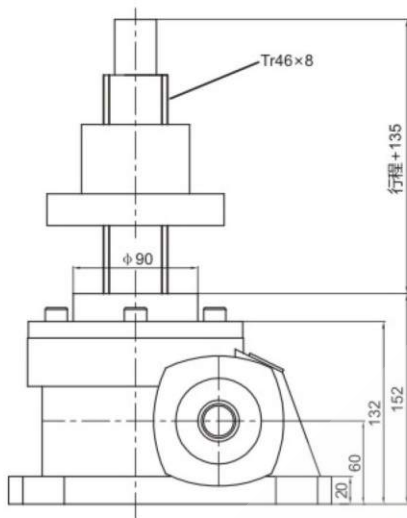

2B螺母在下

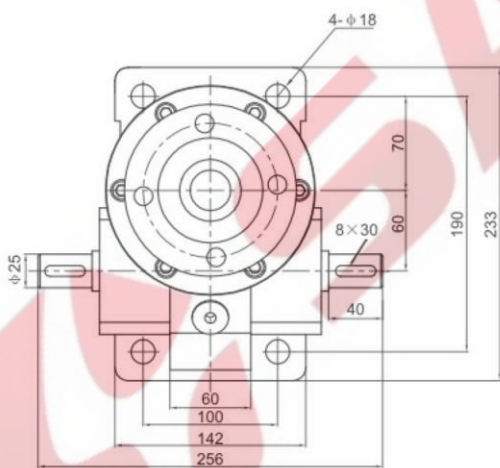
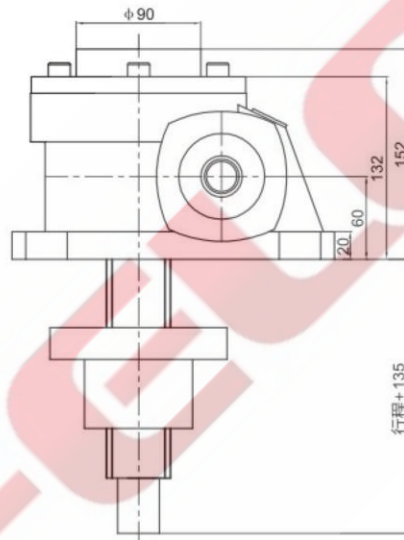

丝杆头部可选

I型

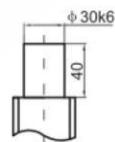

III型

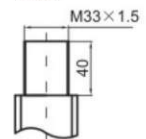

2型丝杆螺母

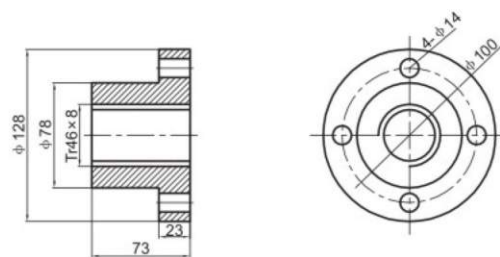

轴指向 Shaft Direction

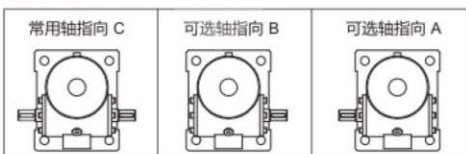

HK..

HK15T II型结构

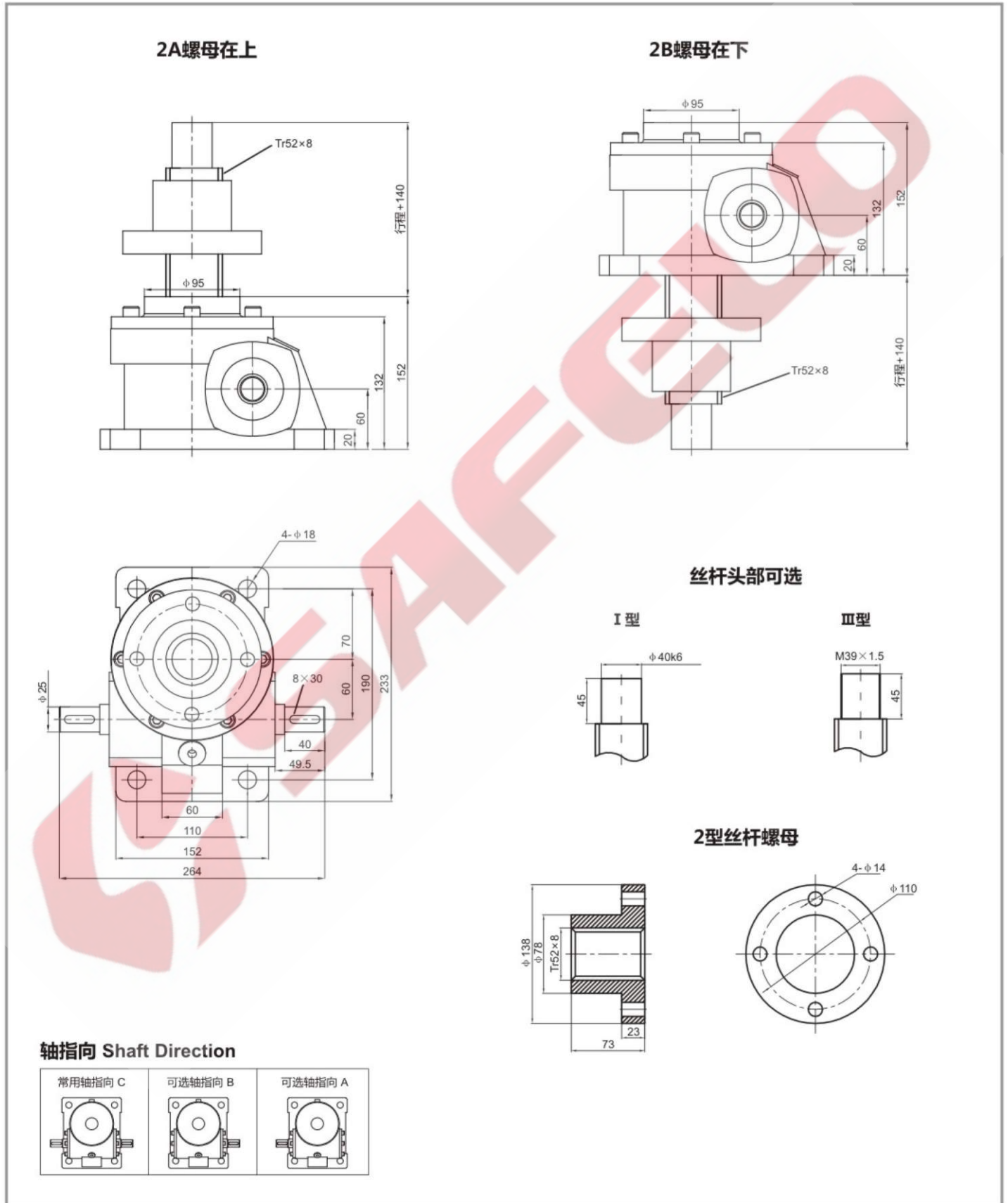

HK

HK20T II型结构

2A螺母在上

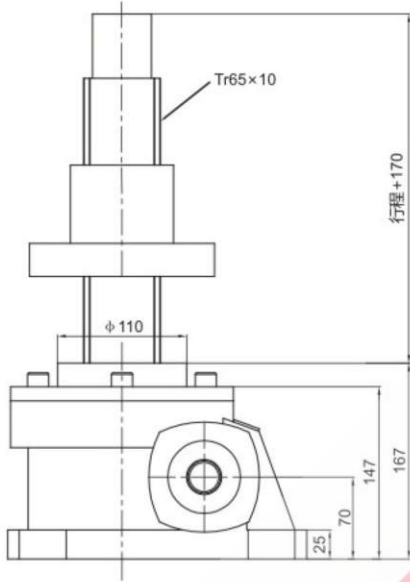

2B螺母在下

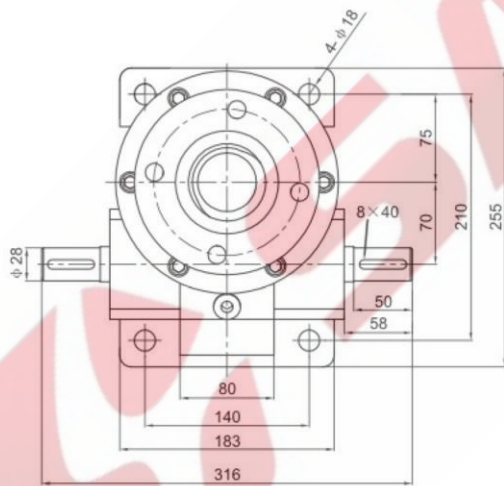
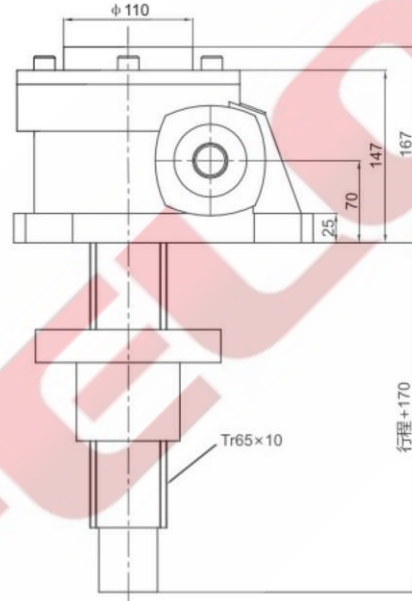

丝杆头部可选

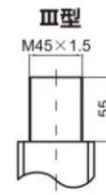
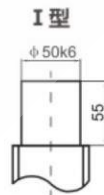

2型丝杆螺母

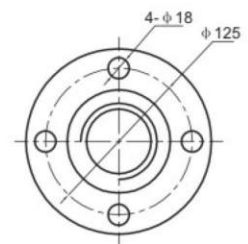
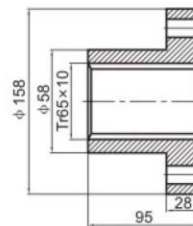

轴指向 Shaft Direction

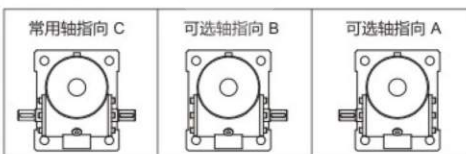

HK..

HK30T II型结构

2A螺母在上

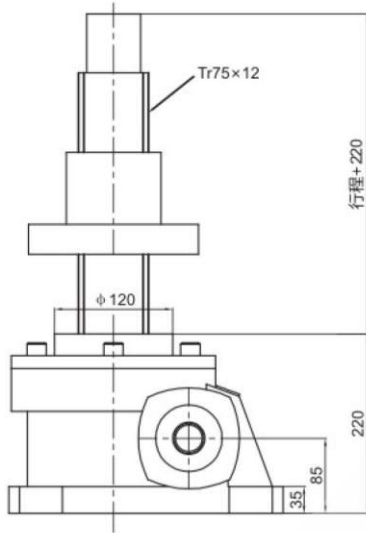

2B螺母在下

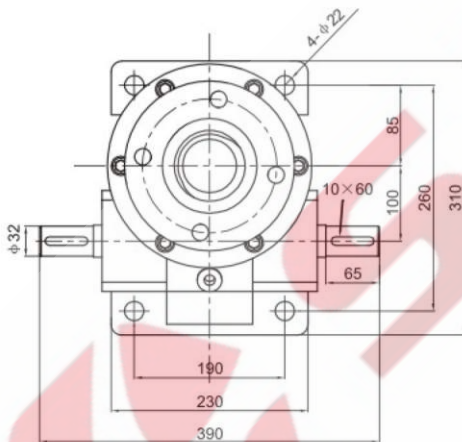
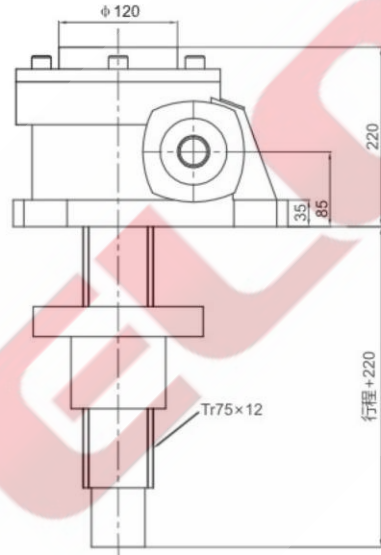

丝杆头部可选

I型

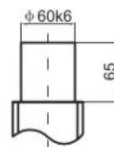

III型

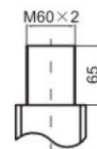

2型丝杆螺母

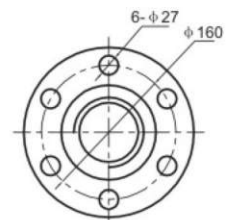
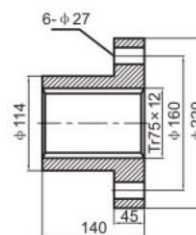

轴指向 Shaft Direction

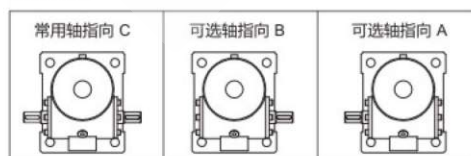

HK

HK40T II型结构

2A螺母在上

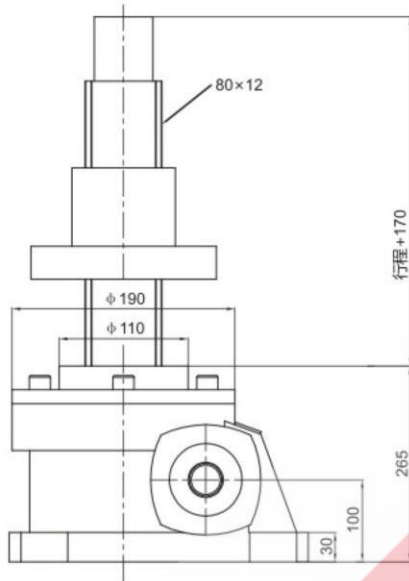

2B螺母在下

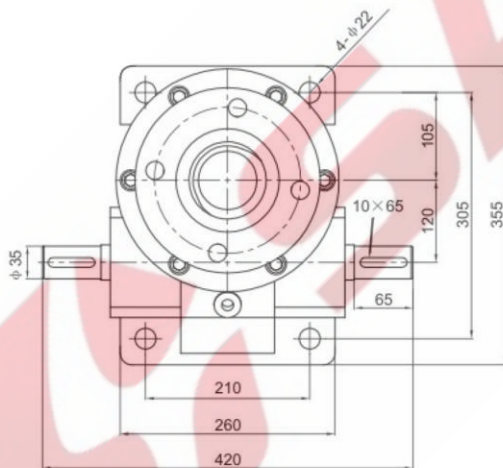
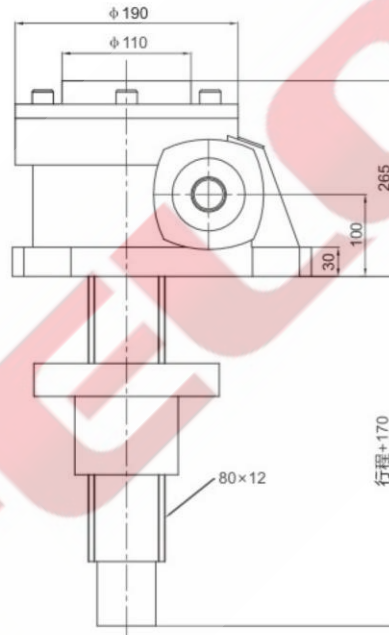

丝杆头部可选

I型

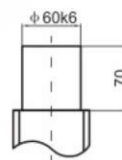

III型

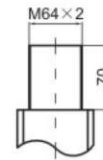

2型丝杆螺母

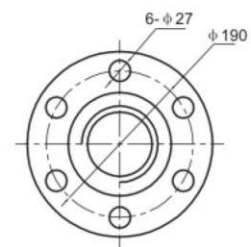
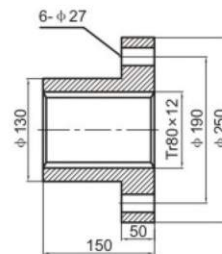

轴指向 Shaft Direction

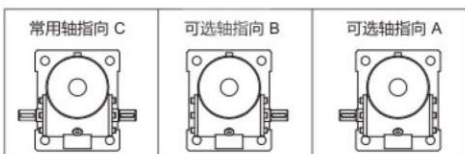

HK..

HK50T II型结构

2A螺母在上

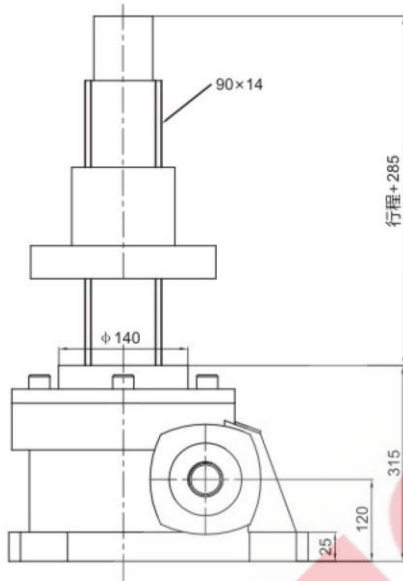

2B螺母在下

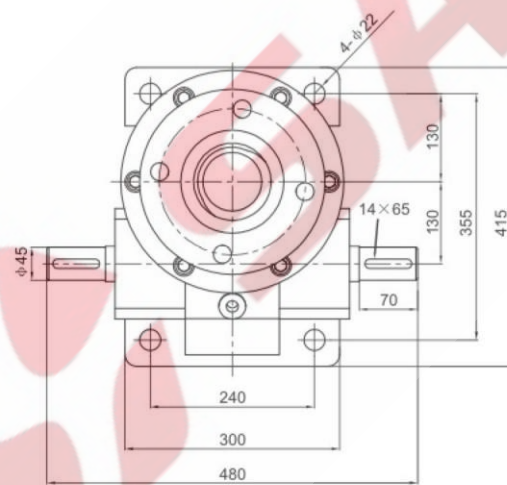
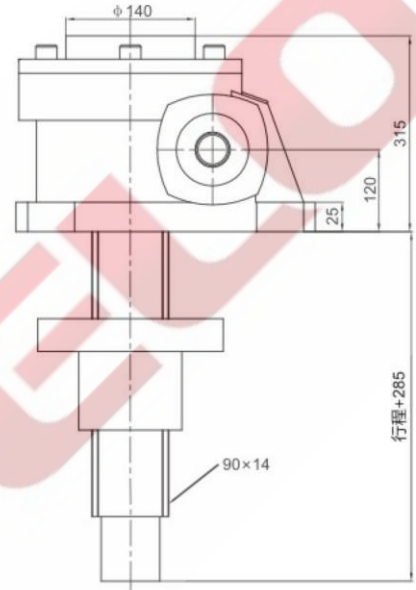

丝杆头部可选

I 型

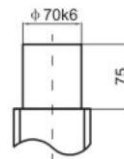

III 型

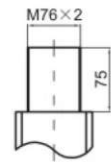

2型丝杆螺母

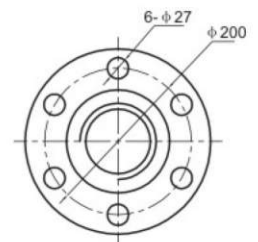
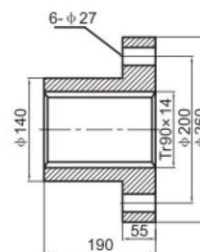

轴指向 Shaft Direction

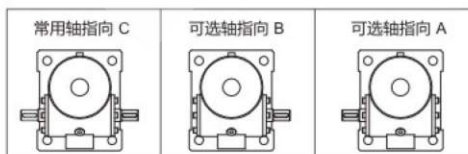

HK100T II型结构

2A螺母在上

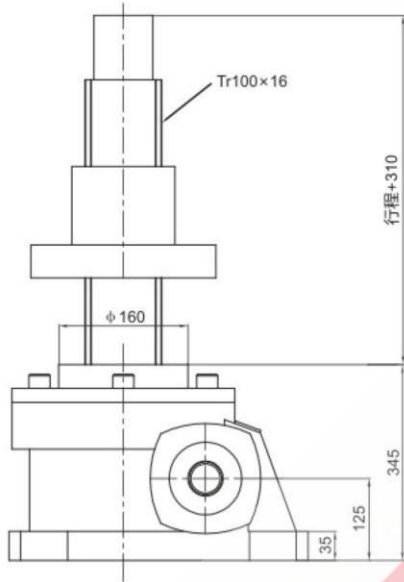

2B螺母在下

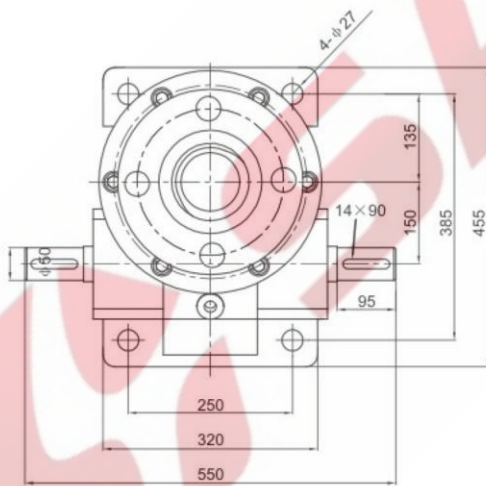
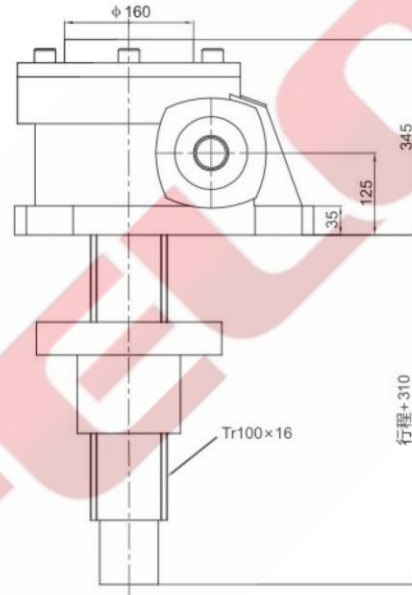

丝杆头部可选

I 型

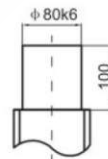

III 型

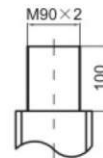

2型丝杆螺母

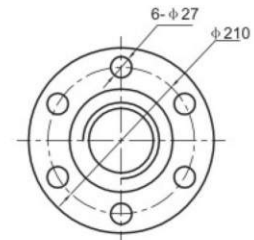
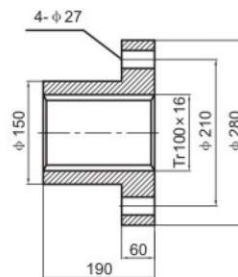

轴指向 Shaft Direction

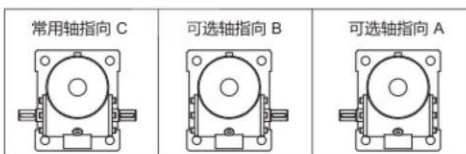

HK

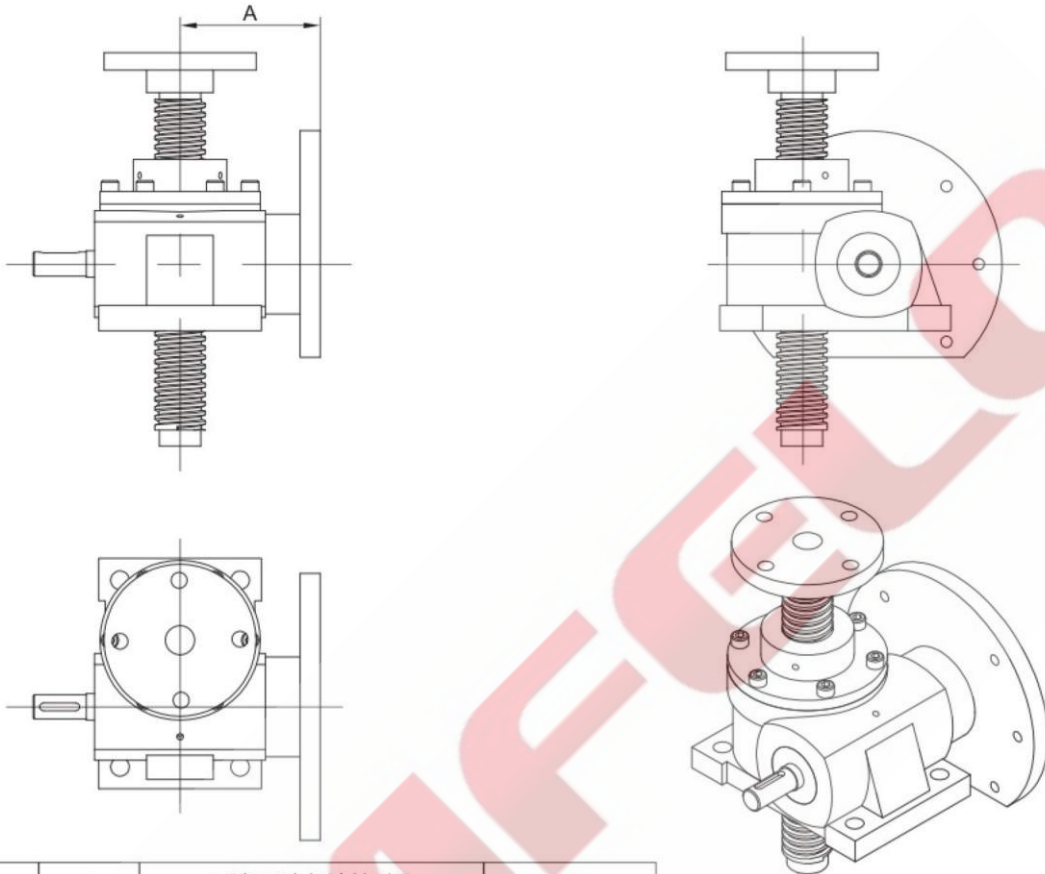

DHK系列型号	+	可选IEC电机法兰型号		A
DHK2T	+	71B5	71B14	76
DHK3T	+	71B5	71B14	91
DHK5T	+	80B5	80B14	105
DHK10T	+	90B5	90B14	125
DHK15T	+	90B5	90B14	125
DHK20T	+	90B5	90B14	142.5

DHK 5T - 6 - 1 - A - II - 100 - FZ - C - 71B5 + 电机型号

1 2 3 4 5 6 7 8 9 10 11

1. **DHK** : 系列号, DHK系列-蜗轮+T型丝杆升降机, 带IEC电机接口型;
2. **5T** : 型号, 以升降机的静载能力作为型号; 主要有: 2T, 3T, 5T, 10T, 15T, 20T, 30T, 40T, 50T, 100T;
3. **6** : 升降机的速比;
4. **1** : 结构型号; 1型: 螺母作旋转运动、丝杆作轴向运动 (本页展示的产品均为I型); 2型: 丝杆作旋转运动、螺母作轴向运动;
5. **A** : 装配型式; A型: 丝杆 (或螺母) 向上 (安装面) 移动; B型: 丝杆 (或螺母) 向下 (安装面) 移动;
6. **T** : 丝杆头部型式: 1型丝杆头部为I型 (圆柱型)、II型 (法兰型)、III型 (螺纹型)、IV型 (扁头型) 四种; 2型丝杆头部为I型 (圆柱型)、III型 (螺纹型);
7. **100** : 升降行程; 客户自定义;
8. **FZ** : 丝杆的防旋和防护;
1型结构有基本型、防旋型 (F-键防旋) 和带防护罩型 (Z钢管防护-被动侧, X伸缩管防护-主动侧, Q两种都有);
2型结构有基本型和带防护罩型 (X伸缩管防护-主动侧);
9. **C** : 轴指向A; B; C; D;
10. **71B5** : IEC 输入接盘型号;
11. **电机型号** : 需要我司配电机时填写, 电机型号参数;

轴指向 Shaft Direction

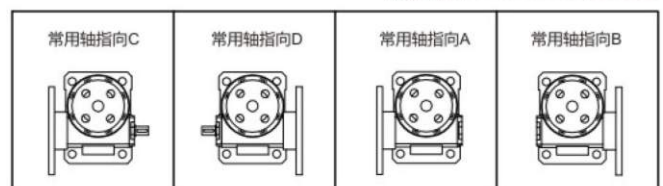

B5 Electric Motors Dimension

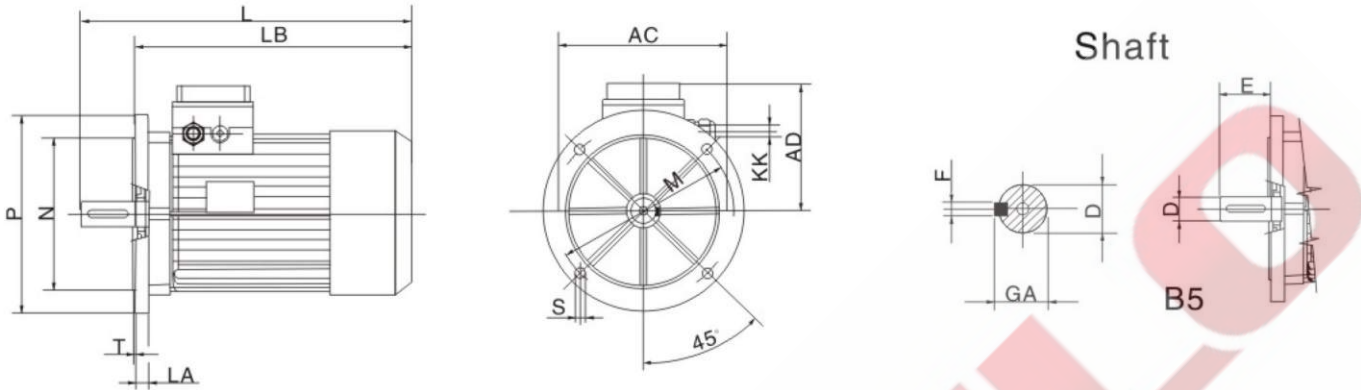

Motor	Overall dim.					Flange B5						Shaft			
	AC	AD	L	LB	KK	M	Nj6	P	LA	S(Ø)	T	D(Ø)	E	F	GA
56	110	96	189	169	M16X1,5	100	80	120	10	7	3	9 M4	20	3	10,2
63	122	96	218	195	M16X1,5	115	95	140	10	9	3	11 M4	23	4	12,5
71	145	125	255	225	M20X1,5	130	110	160	13	10	3,5	14 M5	30	5	16
80	165	135	295	255	M20X1,5	165	130	200	13	12	3,5	19 M6	40	6	21,5
90S	185	145	310	260	M25X1,5	165	130	200	13	12	3,5	24 M8	50	8	27
90L	185	145	335	285	M25X1,5	165	130	200	15	12	3,5	24 M8	50	8	27
100	215	170	380	320	M25X1,5	215	180	250	15	15	4	28 M10	60	8	31
112	240	180	400	340	M25X1,5	215	180	250	15	15	4	28 M10	60	8	31
132S	275	210	470	390	M25X1,5	265	230	300	15	15	4	38 M12	80	10	41
132M	275	210	510	430	M25X1,5	265	230	300	15	15	4	38 M12	80	10	41

B14 Electric Motors Dimension

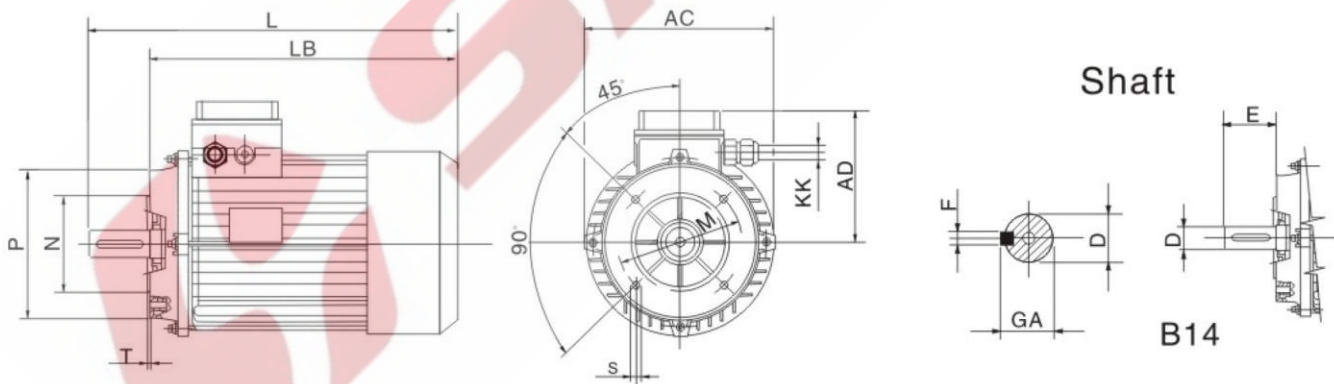

Motor	Overall dim.					Flange B5						Shaft			
	AC	AD	L	LB	KK	M	Nj6	P	LA	S(Ø)	T	D(Ø)	E	F	GA
56	110	96	189	169	M16X1,5	65	50	80	M5	3	3	9 M4	20	3	10,2
63	122	96	218	195	M16X1,5	75	60	90	M5	3	3	11 M4	23	4	12,5
71	145	125	255	225	M20X1,5	85	70	105	M6	3	3	14 M5	30	5	16
80	165	135	295	255	M20X1,5	100	80	120	M6	3	3	19 M6	40	6	21,5
90S	185	145	310	260	M25X1,5	115	95	140	M8	3	3	24 M8	50	8	27
90L	185	145	335	285	M25X1,5	115	95	140	M8	3	3	24 M8	50	8	27
100	215	170	380	320	M25X1,5	130	110	160	M8	4	4	28 M10	60	8	31
112	240	180	400	340	M25X1,5	130	110	160	M8	4	4	28 M10	60	8	31
132S	275	210	470	390	M25X1,5	165	130	200	M10	5	5	38 M12	80	10	41
132M	275	210	510	430	M25X1,5	165	130	200	M10	5	5	38 M12	80	10	41



上海塞弗勒减速机有限公司

地址：上海市金山区亭卫公路1500号

电话：021-56613070 021-56613150

网址：www.cn-safelo.com

SHANGHAI SAFELO DRIVE CO.,LTD.

ADD: 1500 Tingwei Road, Jinshan District, Shanghai

TEL: 021-56613070 021-56613150

www.cn-safelo.com